

3D FLASH+

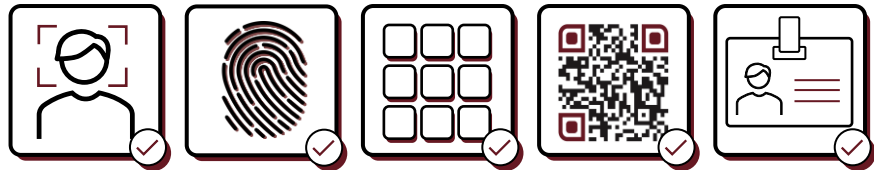

3D FLASH+ is a fast & secure Face Reader for in- and outdoor applications

---

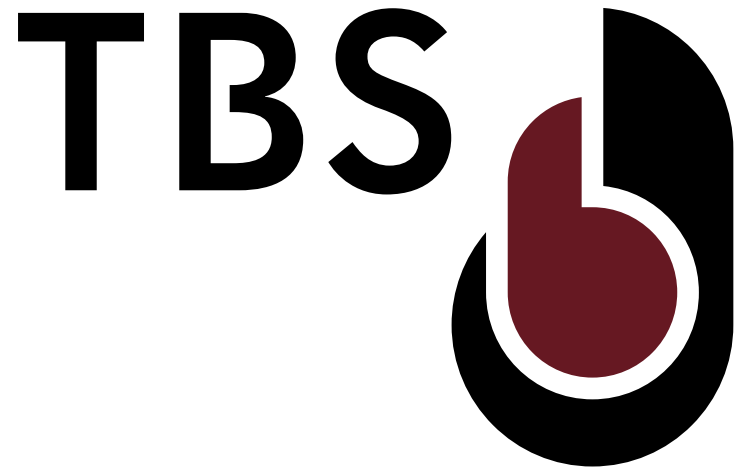
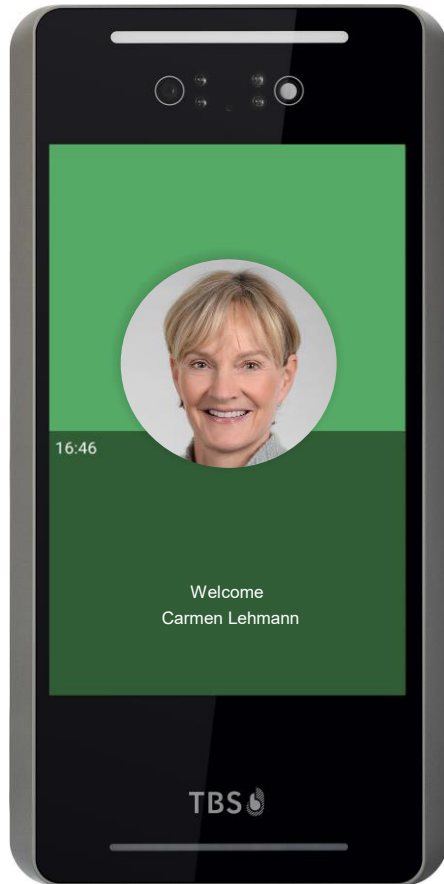

- (1) Walk-through face identification
- (2) High speed < 1 second
- (3) Recognition distance up to 4 m
- (4) Up to 50'000 users
- (5) 8-inch color touchscreen
- (6) Powered by highly secure TBS firmware
- (7) TBS Anti-spoofing protection
- (8) PIN Code, QR Code
- (9) Various RFID options
- (10) Flexible combination of ID factors
- (11) Easy setup of Time & Attendance buttons
- (12) Versatile configuration and customizing (customer workflows, user interface)

Face enrollment possibilities of the TBS ecosystem:

- (1) On device using touchscreen
- (2) On device via remote control
- (3) On tablet with TBS App
- (4) On mobile phone with TBS App
- (5) On desktop webcam
- (6) Picture import from external sources

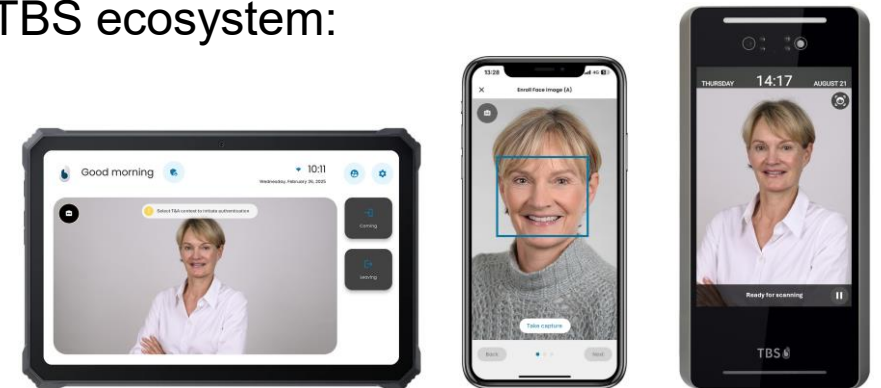

# DATASHEET 3D FLASH+



## TECHNICAL SPECIFICATIONS

Category	Feature	Standard	Optional
<b>Biometric Sensor</b>	Face Recognition	0.5 - 4m	
	Fingerprint 2D optical		•
<b>ID Factors</b>	PIN	•	
	RFID		•
	QR Code		•
<b>User Interface</b>	Touchscreen size	8"	
	Touchscreen Resolution	800 × 1280	
	Loudspeaker	•	
<b>Biometrics</b>	Identification (1:N) database limit	10'000	50'000
	FRR at FAR 1:100'000	< 2.0%	
<b>Communication</b>	LAN	•	
<b>Interfaces</b>	RS-485 (OSDP) / RS-232	1 / 1	
	Wiegand out	1	
	Relay (NO/NC/COM, max. 60V/30W)	2	
	GPIN / GPOUT	2	
<b>Security</b>	Presentation Attack Detection (PAD)	•	
	Tamper Switch	•	
<b>Installation</b>	Power supply rating	15-24 VDC	
	Max. power consumption	12 W	
	Operating temperature	-20 to 60 °C	
	Operating humidity	10 to 90%	
	Indoors: Wall mount WM-Box (IP30)	•	
	Outdoors: Outdoor Kit (IP65)		•
<b>Certifications</b>	CE, FCC/IC, KC, BIS	•	

## ACCESSORIES & FEATURES

Power supply and wall mounting plate included.

### Hardware Extensions (optional):

- Integrated RFID reader  
HF: MIFARE Classic/DESFire, HID iCLASS, LEGIC  
LF: HID Prox, other formats on request
- Fingerprint Sensor Module (optical) compliant to other TBS fingerprint technologies and devices
- TBS CONTROLLER SMART+ with 4 relays, 4 GPIN, 4 GPOUT, RS-485 or LAN communication
- TBS CONTROLLER LITE with 2 relays, 2 GPIN/GPOUT, RS-485
- Outdoor Kit: Protection box, Outdoor Roof and Sealing

### Software Extensions (licensed):

- QR Code Reading: Power Package «Multi-Factor» required
- Extended Identification (1:N) limit with BIOMANAGER Premium Plan

### TBS System Security:

- Multi-level data encryption, with option to define a custom Template Encryption Key
- Protected communication channels (SSL) with option to use custom SSL certificates

### Seamless Integration:

- Device connects to TBS BIOMANAGER Server hosted On-Premise or in the TBS Cloud
- Flexible integration options
  - REST APIs on system and device level available
  - Enrollment integration into 3rd party software supported
- Flexible and versatile Enrollment Options: On-Device, Web enrollment from TBS BIOMANAGER, TBS Apps or external data import

## DIMENSIONS

### Wall mount

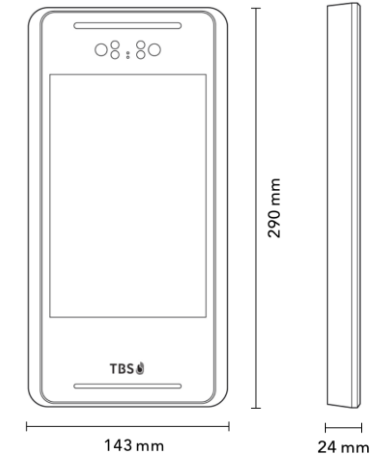

## CUSTOMIZING

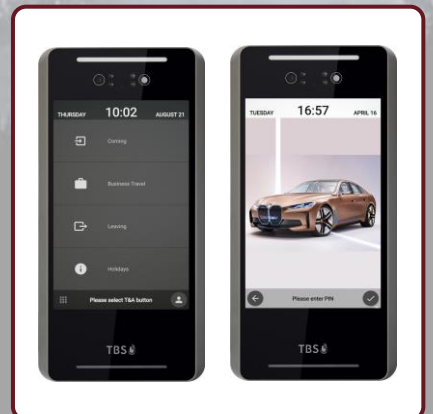

# MORE THAN JUST A READER

## FIVE REASONS FOR YOUR CHOICE

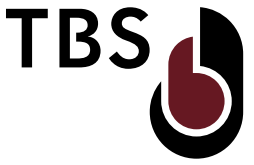

### (1) EUROPEAN COMPETENCE YOU CAN TRUST

Swiss perfection, German thoroughness and Czech ingenuity - built on integrity and reliability.

### (2) TAILOR-MADE FOR DEMANDING CLIENTS

From the world's top-rated airport to the No.1 Department of Defence, TBS is the undisputed leader in bespoke solutions.

### (3) ALL-IN-ONE PLATFORM

We deliver the full spectrum: multiple biometric technologies on one powerful platform, integrated with all major security providers.

### (4) PARTNERSHIP BEYOND THE PROJECT

For us, winning a project is only the beginning. Long-term service & support is what truly separates the wheat from the chaff.

### (5) THE VALUE OF A QUALITY INVESTMENT

More performance & flexibility – less risk

LET'S GET TO WORK



TRUST BIOMETRICS  
SERVICES **COMPETENCE**  
SPECIALIST FLEXIBILITY QUALITY  
HOSPITALITY TERMINALS **TERMINALS**  
TRUST BIOMANAGER  
TOP-REFERENCES SOFTWARE  
SWISS **TBS** **QUALITY**  
DURABILITY TOUCHLESS RELIABILITY SERVICES **LONGTERM**  
**INTEGRITY SECURITY**  
MANUFACTURER COMPETENCE

